

DE Brausearmatur / Wannenarmatur  
EN Shower fitting / Bath fitting  
FR Robinet de douche / Robinet de baignoire  
IT Miscelatore doccia / Miscelatore vasca  
NL Douchekraan / Badkraan  
SE Duschblandare / Badkarsblandare  
CZ Sprchová baterie / Vanová baterie  
SK Sprchová batéria / Vaňová batéria  
RO Baterie duș / Baterie cadă  
PL Bateria prysznicowa / Bateria wannowa

# Jungborn®

SERIES **ZETA**

Art. 12028684 / 12028685

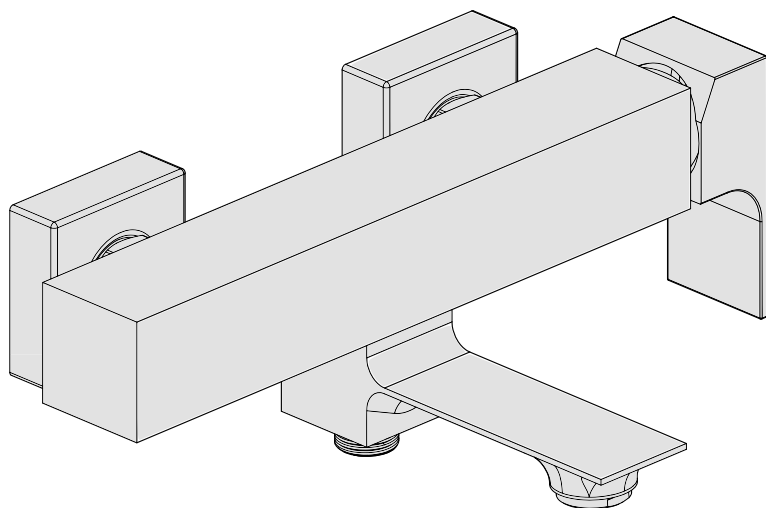

12028685

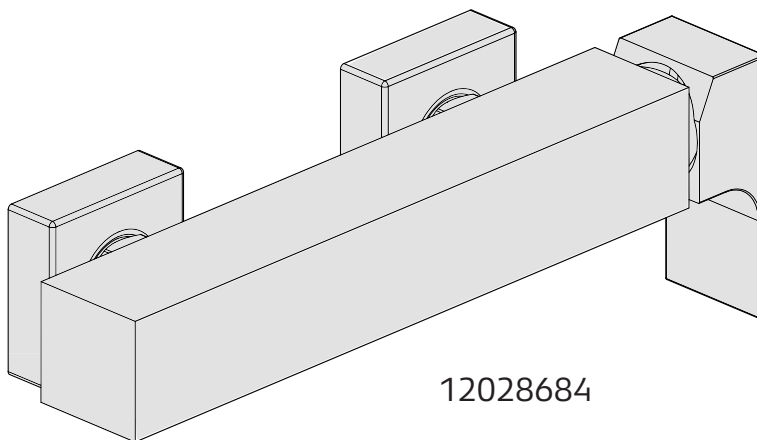

12028684

DE Brausearmatur / Wannenarmatur  
EN Shower fitting / Bath fitting  
FR Robinet de douche / Robinet de baignoire  
IT Miscelatore doccia / Miscelatore vasca  
NL Douchekraan / Badkraan  
SE Duschblandare / Badkarsblandare  
CZ Sprchová baterie / Vanová baterie  
SK Sprchová batéria / Vaňová batéria  
RO Baterie duș / Baterie cadă  
PL Bateria prysznicowa / Bateria wannowa

SERIES **ZETA**

Art. 12028684 / 12028685

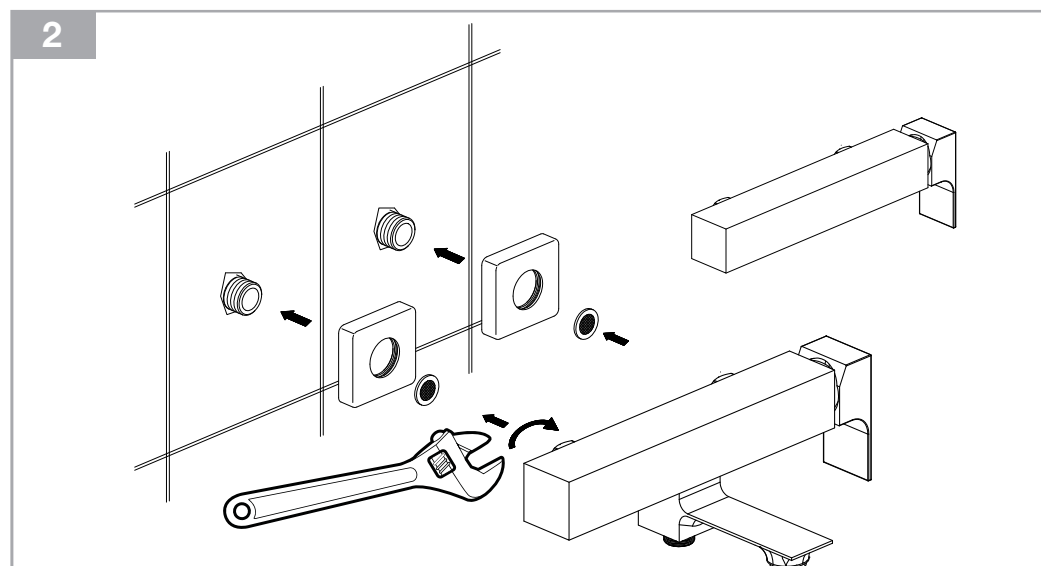
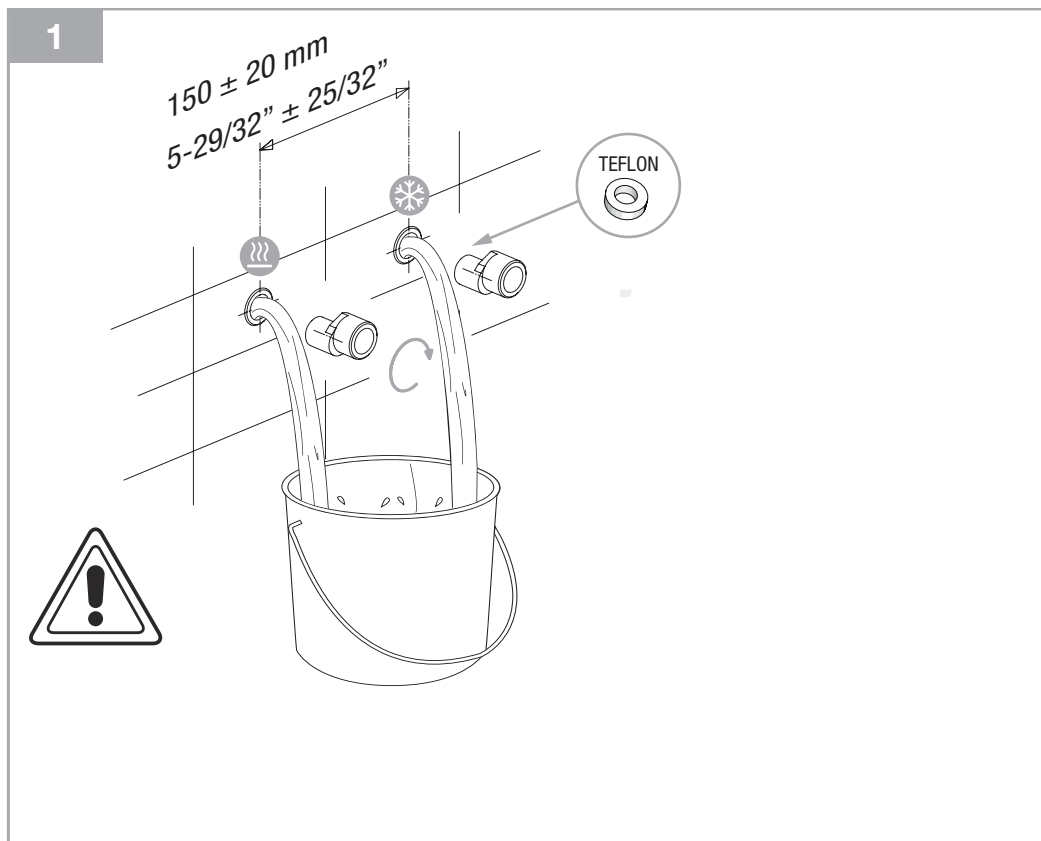

DE Brausearmatur / Wannenarmatur  
EN Shower fitting / Bath fitting  
FR Robinet de douche / Robinet de baignoire  
IT Miscelatore doccia / Miscelatore vasca  
NL Douchekraan / Badkraan  
SE Duschblandare / Badkarsblandare  
CZ Sprchová baterie / Vanová baterie  
SK Sprchová batéria / Vaňová batéria  
RO Baterie duș / Baterie cadă  
PL Bateria prysznicowa / Bateria wannowa

# Jungbörn®

SERIES **ZETA**

Art. 12028684 / 12028685

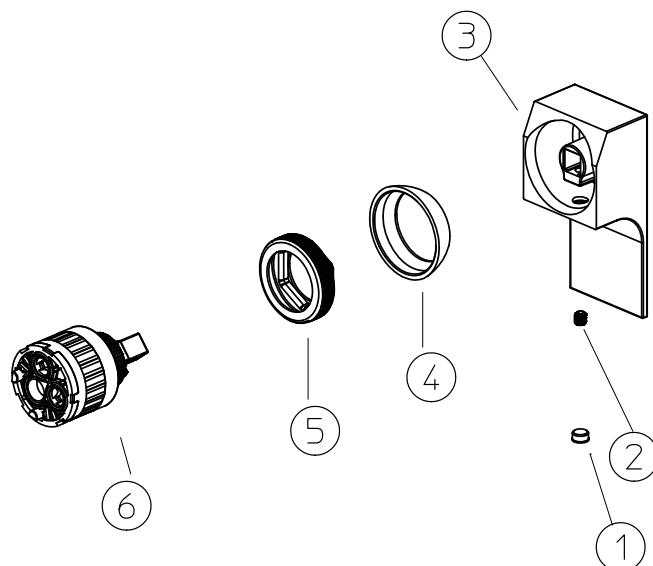
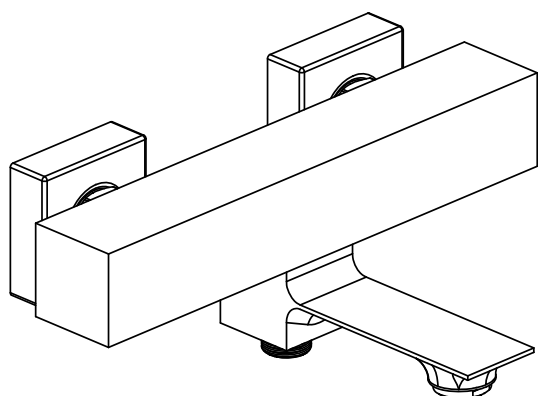

DE Brausearmatur / Wannenarmatur  
EN Shower fitting / Bath fitting  
FR Robinet de douche / Robinet de baignoire  
IT Miscelatore doccia / Miscelatore vasca  
NL Douchekraan / Badkraan  
SE Duschblandare / Badkarsblandare  
CZ Sprchová baterie / Vanová baterie  
SK Sprchová batéria / Vaňová batéria  
RO Baterie duș / Baterie cadă  
PL Bateria prysznicowa / Bateria wannowa

# Jungbörn®

SERIES **ZETA**

Art. 12028684 / 12028685

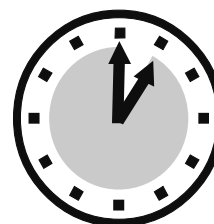
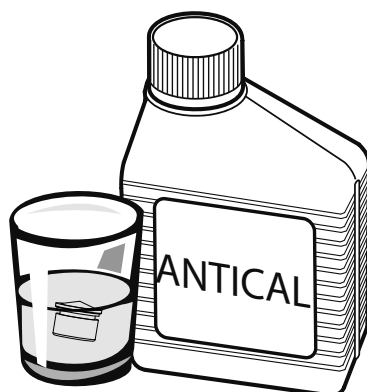
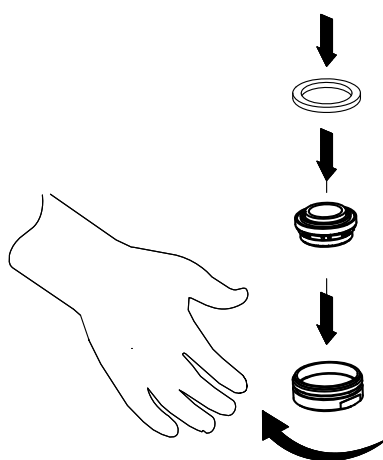
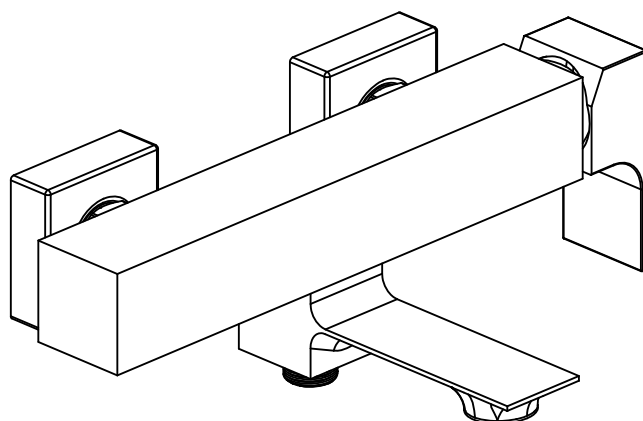

1H

DE Brausearmatur / Wannenarmatur  
EN Shower fitting / Bath fitting  
FR Robinet de douche / Robinet de baignoire  
IT Miscelatore doccia / Miscelatore vasca  
NL Douchekraan / Badkraan  
SE Duschblandare / Badkarsblandare  
CZ Sprchová baterie / Vanová baterie  
SK Sprchová batéria / Vaňová batéria  
RO Baterie duș / Baterie cadă  
PL Bateria prysznicowa / Bateria wannowa

# Jungbörn®

SERIES **ZETA**

Art. 12028684 / 12028685

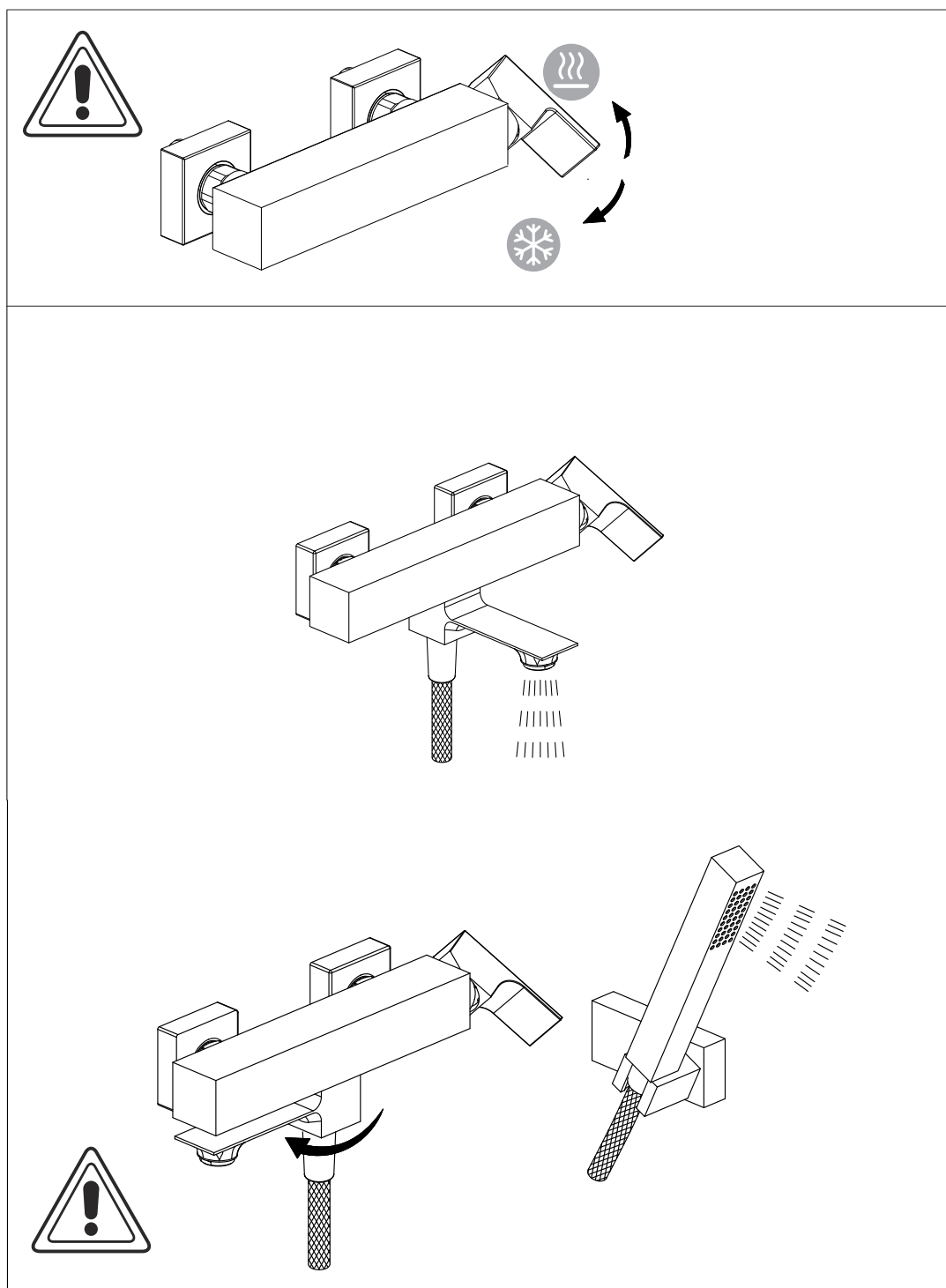

DE Brausearmatur / Wannenarmatur  
 EN Shower fitting / Bath fitting  
 FR Robinet de douche / Robinet de baignoire  
 IT Miscelatore doccia / Miscelatore vasca  
 NL Douchekraan / Badkraan  
 SE Duschblandare / Badkarsblandare  
 CZ Sprchová baterie / Vanová baterie  
 SK Sprchová batéria / Vaňová batéria  
 RO Baterie duș / Baterie cadă  
 PL Bateria prysznicowa / Bateria wannowa

# Jungborn®

SERIES **ZETA**

Art. 12028684 / 12028685

	(D) Empfohlen (I) Consigliato (S) Rekommenderat (SK) Odporúčané	(F) Recommandé (NL) Aanbevolen (CZ) Doporučeno (RO) Recomandat	(D) Höchstens (I) Massimo (S) Maximal (SK) Maximum	(F) Maximum (NL) Maximum (CZ) Maximum (RO) Maxim
(D) Betriebsdruck (F) Pression de fonctionnement (I) Pressione di esercizio (NL) Bedrijfsdruk (S) Driftstryck (CZ) Provozní tlak (SK) Prevádzkový tlak (RO) Presiunea de funcționare	0.5-5 bar		10 bar	
(D) Wassertemperatur (F) Température de l'eau (I) Temperatura dell'acqua (NL) Watertemperatuur (S) Vattentemperatur (CZ) Teplota vody (SK) Teplota vody (RO) Temperatura apei	55-65°C		90°C	
(D) Wasseranschluss (F) Raccordement d'eau (I) Allaccio acqua (NL) Watertoever (S) Vattenanslutning (CZ) Vodní přípojka (SK) Vodná prípojka (RO) Racord de apă	(D) warm = links / kalt = rechts (F) chaude = à gauche / froid = à droite (I) calda = sinistra / fredda = destra (NL) warm = naar links / koud = naar rechts (S) varmt = vänster / kallt = höger (CZ) teplá = vlevo / studená = vpravo (SK) teplá = vľavo / studená = vpravo (RO) cald = stânga / rece = dreapta			